

2026 Sew Flake Mystery Quilt Challenge

June: Block Two

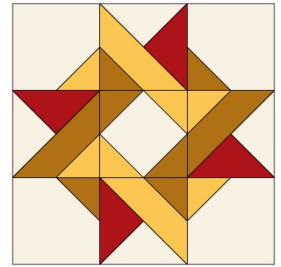

Block Two: Entwined Star

You will need 4 Fabrics:



Julie's Note: Watch cutting instructions carefully. Assign fabrics here to help keep them straight. Use the coloring page to choose fabrics. Cutting a small piece and gluing it to the spot, helps to keep them straight in your mind.

1 – Cut:

- Background Fabric:
 - **Cut** (1) 4 1/2" x 23" strip then **Sub Cut** (5) 4 1/2" squares
 - **Cut** (1) 5 1/4" square then **Sub Cut** on BOTH diagonals
- Fabric One (Twine One Fabric):
 - **Cut** (1) 2 1/2" x 16" strip then **Sub Cut** (6) 2 1/2" squares
 - **Cut** (1) 4 7/8" square then **Sub Cut** on one diagonal
- Fabric Two (Twine Two Fabric):
 - **Cut** (1) 2 1/2" x 16" strip then **Sub Cut** (6) 2 1/2" squares
 - **Cut** (1) 4 7/8" square then **Sub Cut** on one diagonal
- Accent Fabric:
 - **Cut** (1) 5 1/4" square then **Sub Cut** on BOTH diagonals

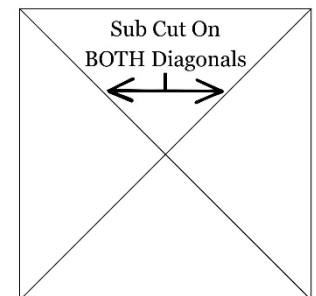
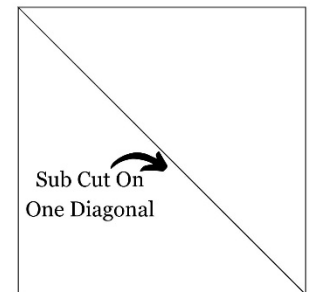

2 – Mark: Mark all (12) 2 1/2" fabric squares with a diagonal line down the middle. This should be done with a light pencil or a removable fabric type of marker. Friction pens work well.

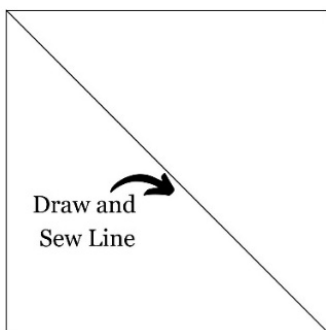

Julie's Note: I sewed these with a scant 1/4", which made a beautiful 4 1/2" finished square.

3 – Sew Corners: Sew (2) 2 1/2" Fabric One (Twine One Fabric) and (2) 2 1/2" Fabric Two (Twine Two Fabric) to the corner of (4) 4 1/2" Background Fabric squares. Trim seam down to the 1/4" and set your seam then press to the dark side. See diagram.

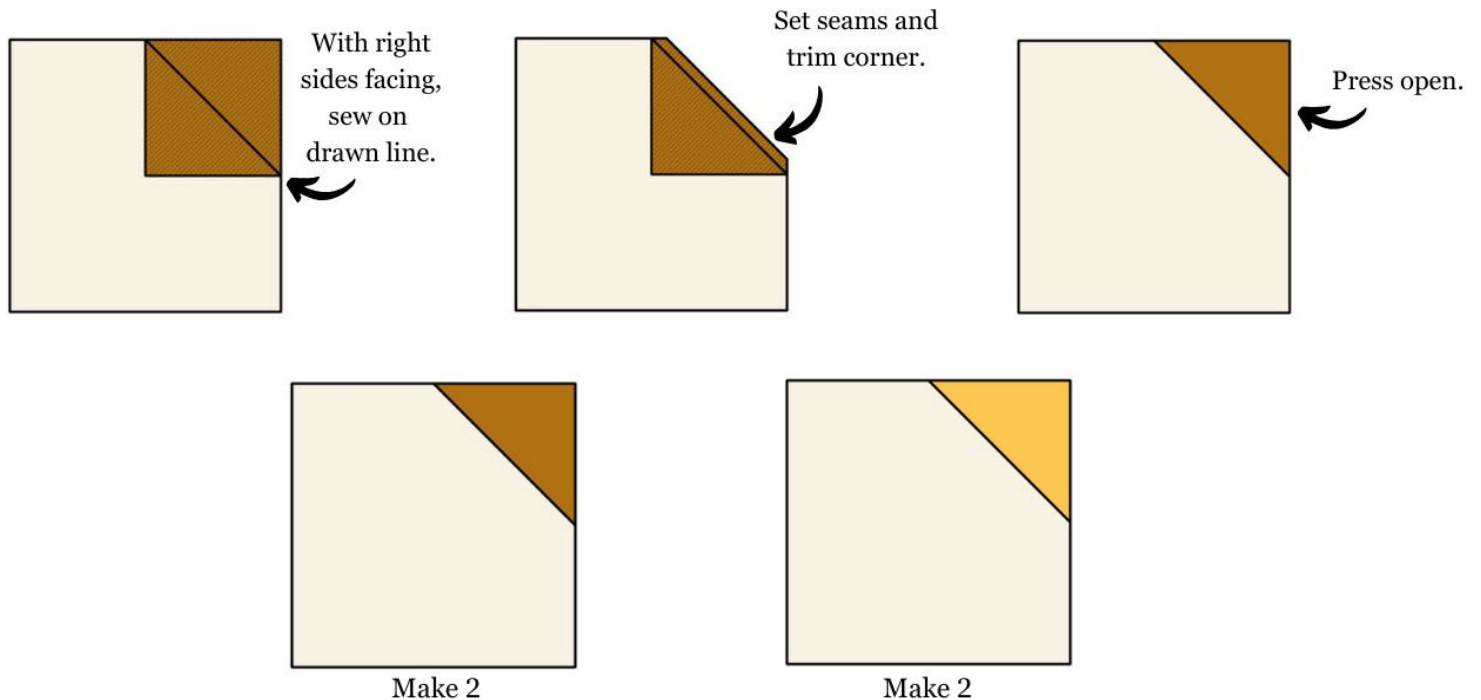

4 – Sew Middle Blocks: Sew Accent Fabric triangles to Background Fabric triangles. Sew the joined triangle to (2) 7/8" Fabric One (Twine One Fabric) triangles and (2) 7/8" Fabric Two (Twine Two Fabric) triangles to create (4) middle blocks total. Set the seam and press to the colored side. See diagram.

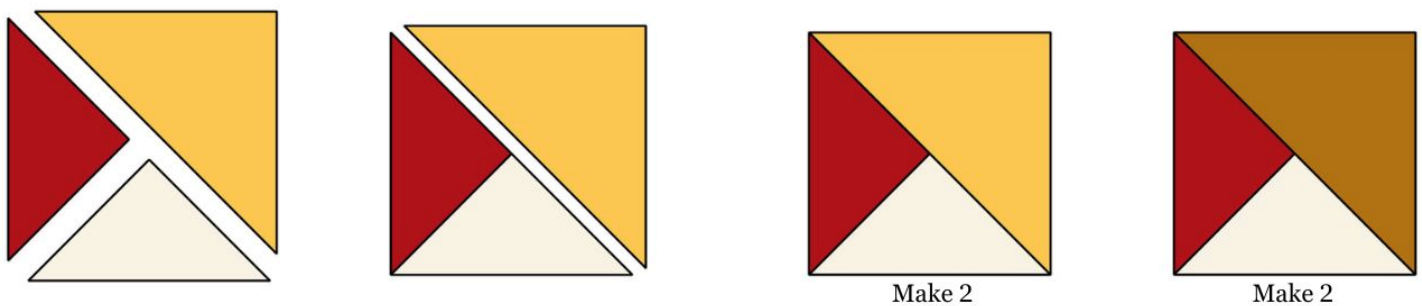

Julie's Note: This corner piece is also recommended sewing a scant 1/4" just as in step 3.

5 – Sew Middle Block Corners: Sew (2) 2 1/2" Fabric One (Twine One Fabric) and (2) 2 1/2" Fabric Two (Twine Two Fabric) to the corner of (4) 4 1/2" Middle Blocks.

NOTE: Ensure the Fabric One (Twine One Fabric) and Fabric Two (Twine Two Fabric) alternate (Fabric One squares go on the Fabric Two triangles, and the Fabric Two squares go on the Fabric One triangles). See diagram.

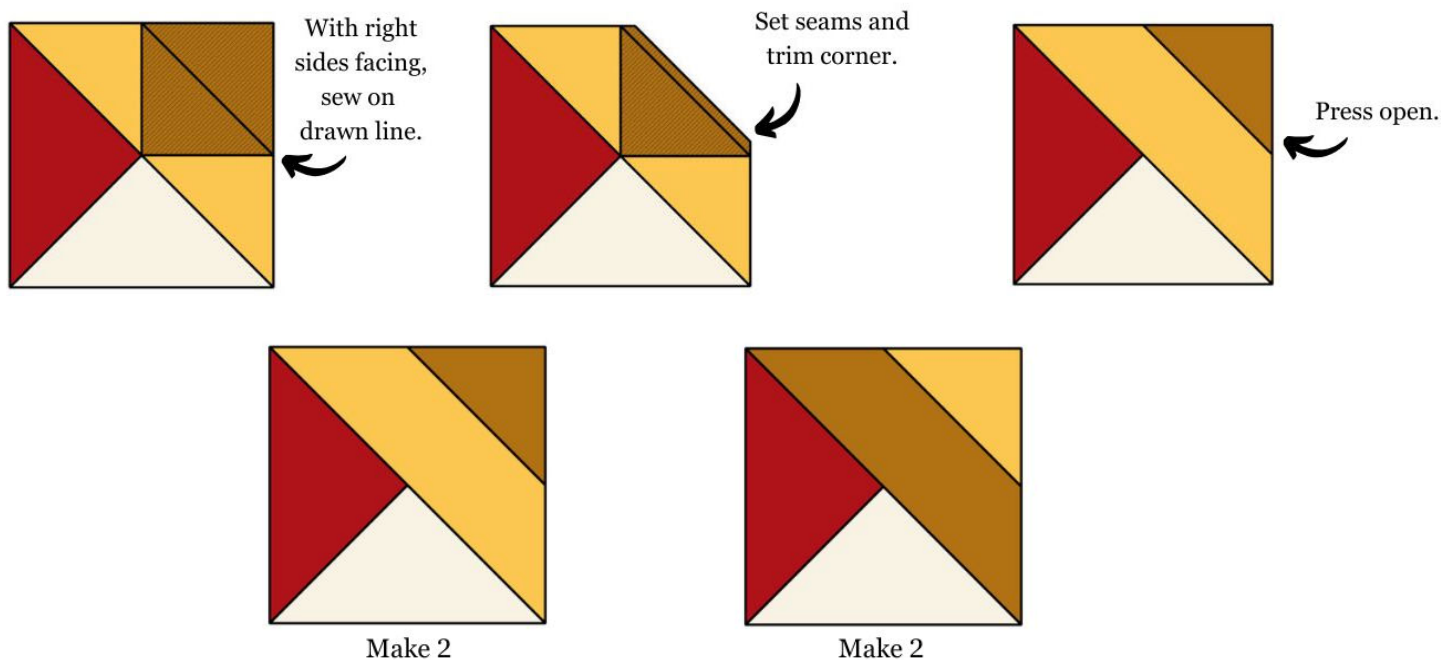

Julie's Note: Refer to the attached instructions for tips on sewing square on point for this next step. The points of the Corner Blocks do not reach the outer edge. This is how it needs to be. There needs to be a 1/4" seam allowance for the future steps

6 – Start Center Block: Sew (2) 2 1/2" Fabric One (Twine One Fabric) to opposite corners of (1) 4 1/2" Background Fabric square. See diagram.

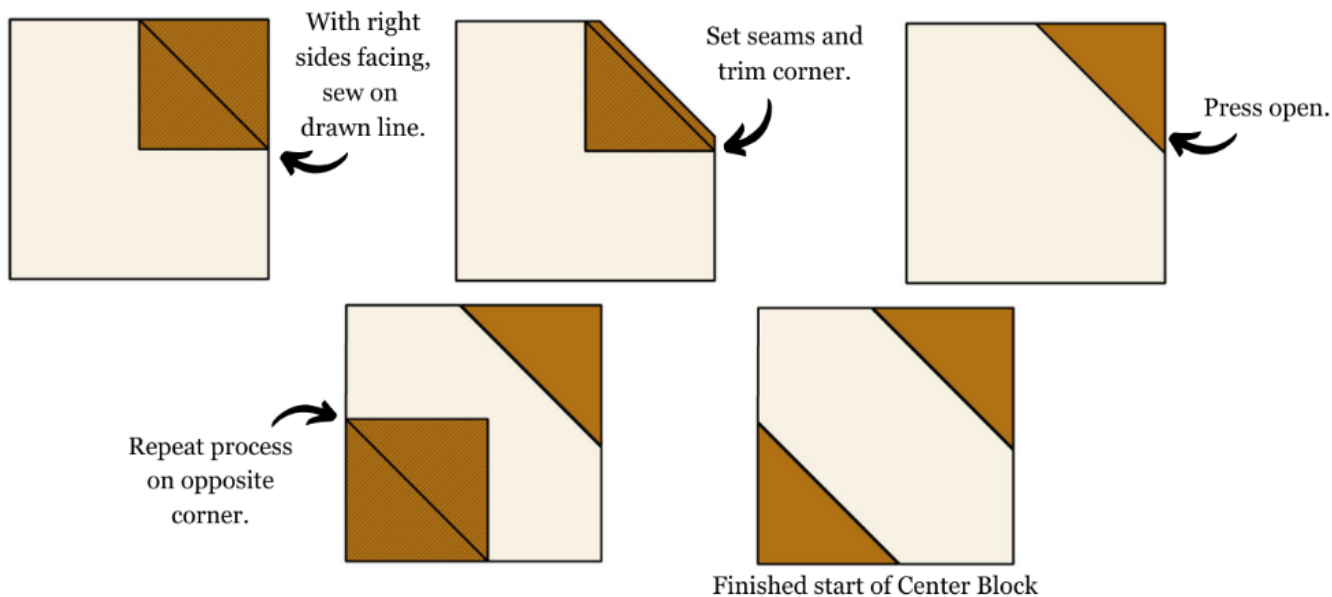

7 – Finish Center Block: Sew (2) 2 1/2" Fabric Two (Twine Two Fabric) to the remaining opposite corners of (1) 4 1/2" Background Fabric square. See diagram.

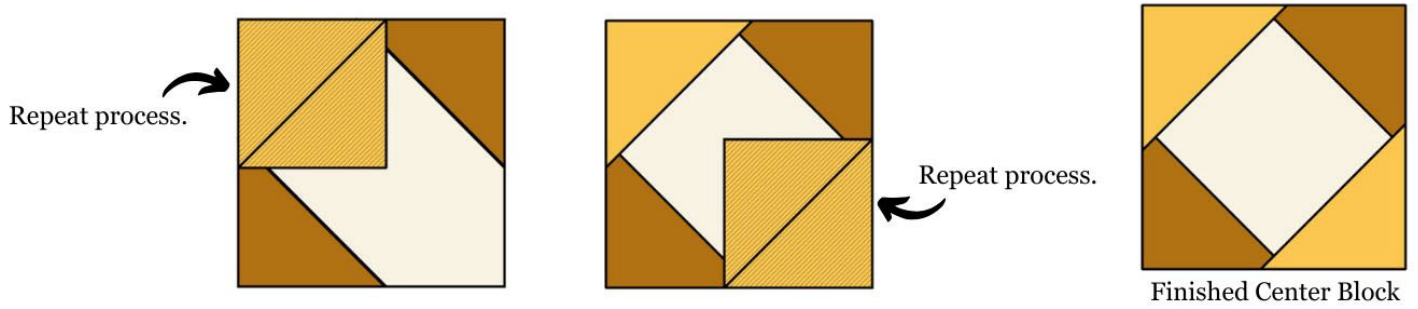

8 – Arrange: Arrange (1) Center Block, (4) Middle Blocks, and (4) Corner Blocks as shown in the diagram. Sew together in order shown in the diagram.

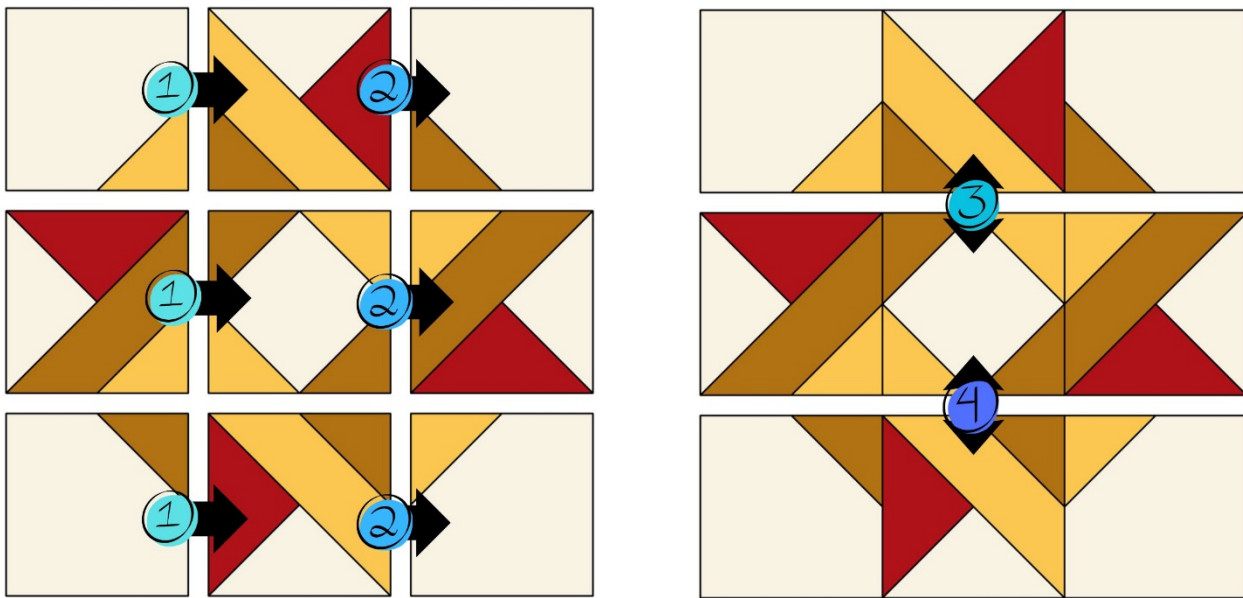

5 – Complete: Your completed block should measure 12.5" square.

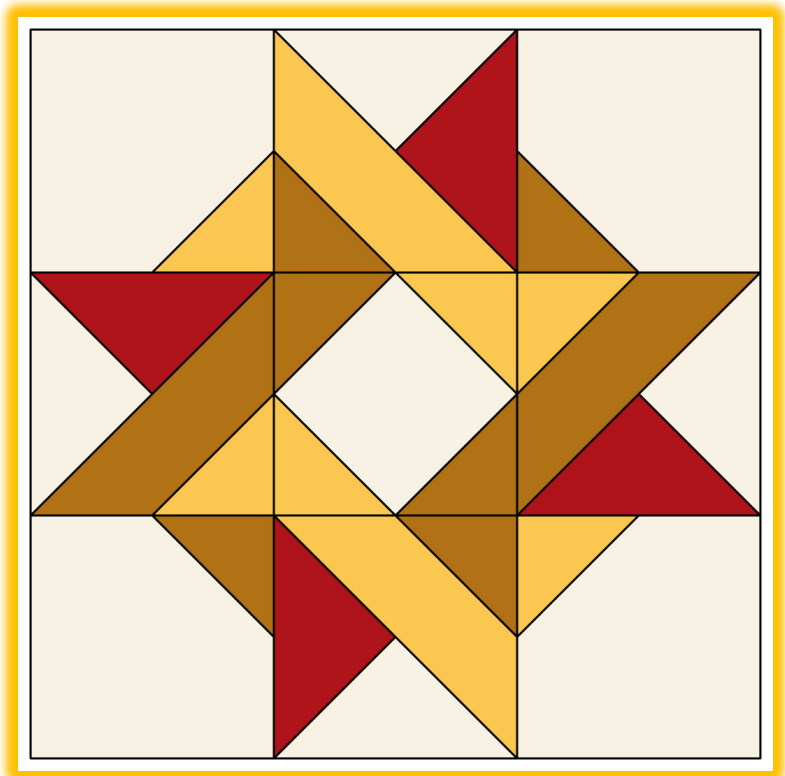

Entwined Star Diagram

Coloring - Fabric Page



Background
Fabric



Fabric One
(Twine One
Fabric)



Fabric Two
(Twine Two
Fabric)



Accent
Fabric

